

THIS DRAWING IS UNPUBLISHED. RELEASED FOR PUBLICATION  
 © COPYRIGHT BY TYCO ELECTRONICS CORPORATION. ALL RIGHTS RESERVED.

LOC	DIST	REVISIONS			
P	LTR	DESCRIPTION	DATE	DWN	APVD
FT	0	S	REVISED PER 0G3B-0095-05	4/1/05	SS GS

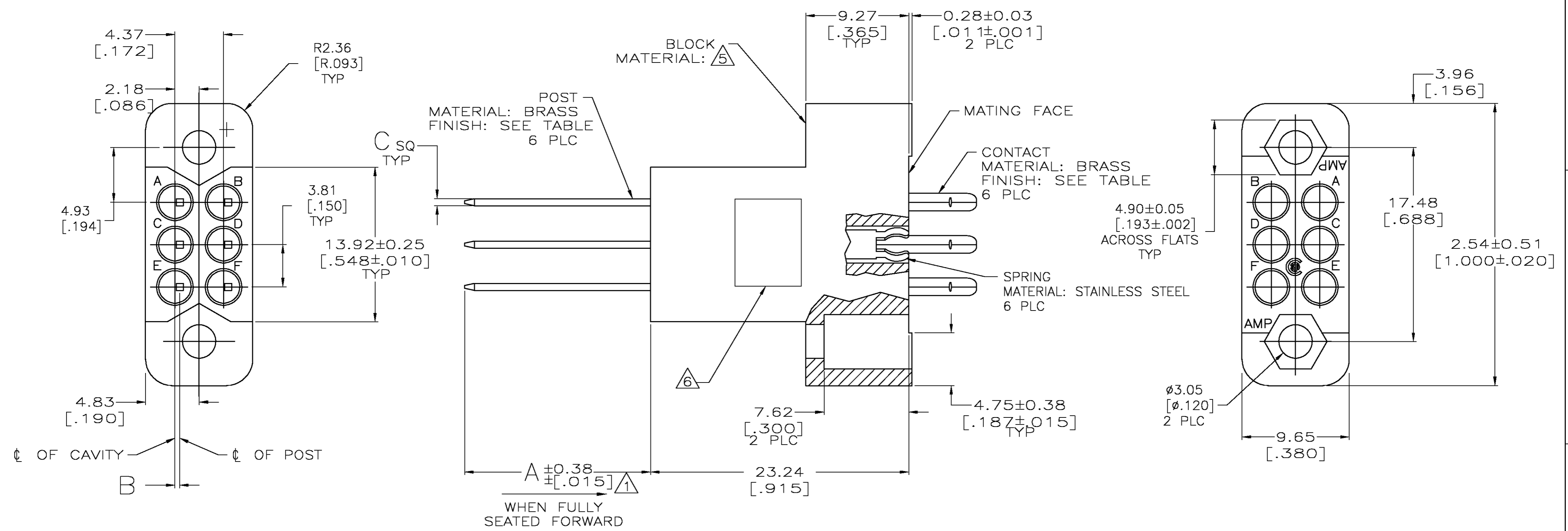

- 1 POSTS ARE SEMI-AUTOMATICALLY WIRABLE AND WILL ACCOMODATE (SEE TABLE) TERMINATIONS.
- 2 #24 AWG MAX WIRE TO BE USED WITH THIS CONNECTOR.
- 3 0.76um[.000030] MIN GOLD FOR A DISTANCE OF 5.08[.200] MIN FROM MATING END. GOLD FLASH ON REMAINDER, ALL OVER 1.27um[.000050] MIN NICKEL.
- 4 2.54um[.000100] MIN TIN-LEAD OVER 1.27um[.000050] MIN NICKEL.
- 5 PHENOLIC, BLACK.
- 6 AMP, PART NUMBER & DATE CODE MARKED IN THIS AREA.
- 7 2.54um[.000100] MIN TIN OVER 1.27um[.000050] MIN NICKEL.

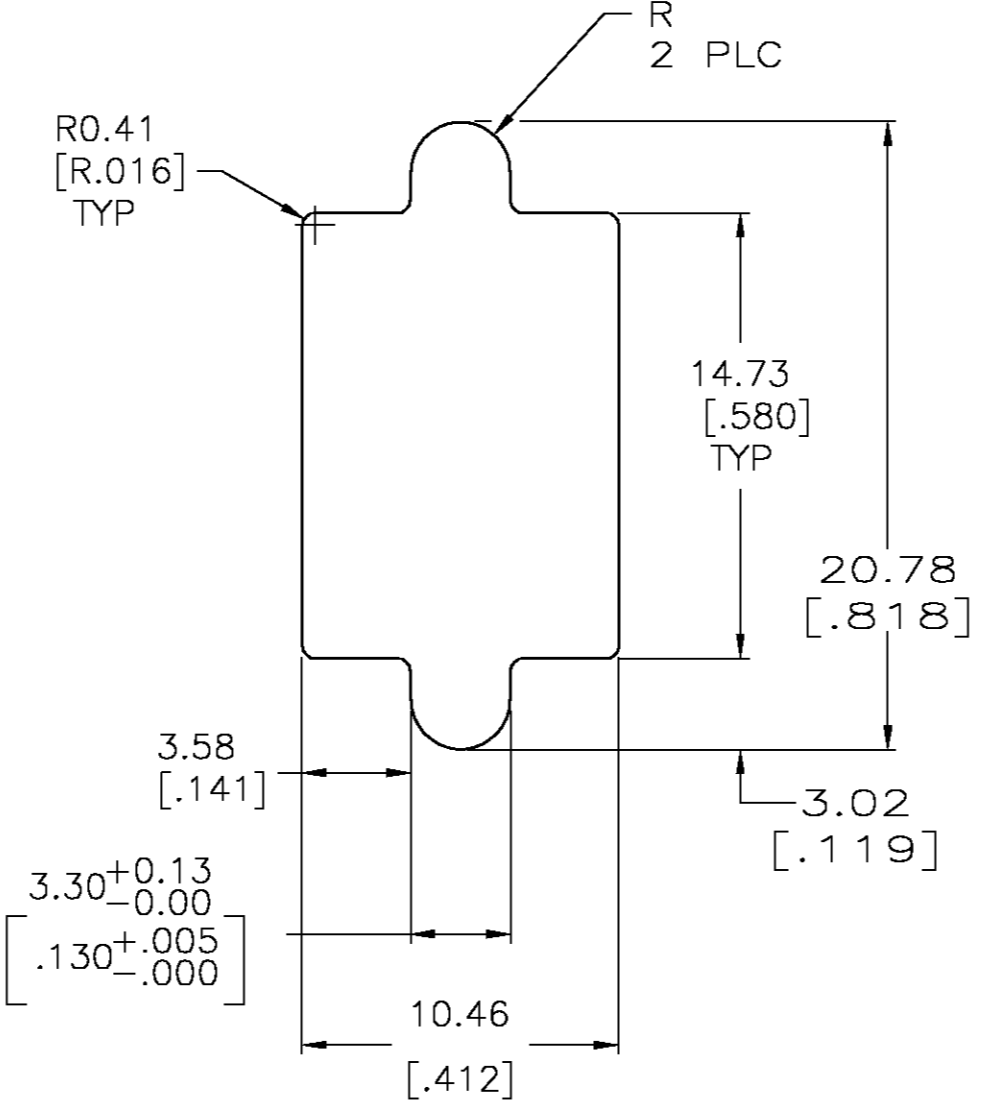

RECOMMENDED PANEL CUTOUT

POST FINISH	C	B	A	CONTACT FINISH	NO OF TERM	PART NUMBER
1	0.64 [.025]	0.43 [.017]	16.74 [.659]	3	3	3-205507-7
2	1.14 [.045]	0.13 [.005]	8.89 [.350]	4	1	3-205507-6
3	0.64 [.025]	0.43 [.017]	16.74 [.659]	3	3	205507-1

THIS DRAWING IS A CONTROLLED DOCUMENT.		DWN	13 OCT 97	Tyco Electronics Corporation Harrisburg, Pa 17105-3608
DIMENSIONS: mm		CHK	24 OCT 97	
TOLERANCES UNLESS OTHERWISE SPECIFIED:		APVD	31 OCT 97	NAME G.STEINHAUER PRODUCT SPEC
0 PLC ± -		APPLICATION SPEC		
1 PLC ± -		WEIGHT		SIZE A2
2 PLC ± 0.13 [.005]		CAGE CODE		
3 PLC ± -		DRAWING NO		RESTRICTED TO -
4 PLC ± -		SCALE		
5 ANGLES ± -		SHEET		1 OF 1
FINISH		REV		
SEE CALLOUTS		CUSTOMER DRAWING		S