

| LTR | EN | DESCRIPTION     | APPR | BY | DATE    |
|-----|----|-----------------|------|----|---------|
| A   | -  | INITIAL RELEASE | RB   | EM | 2-10-04 |

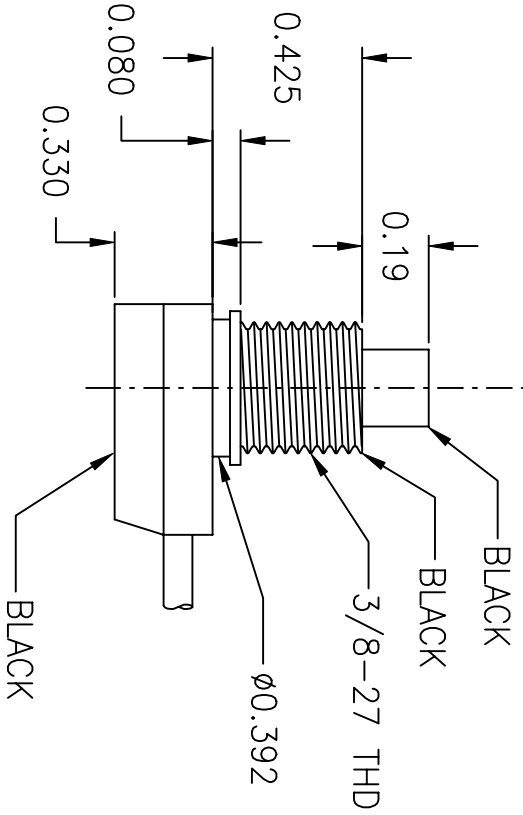
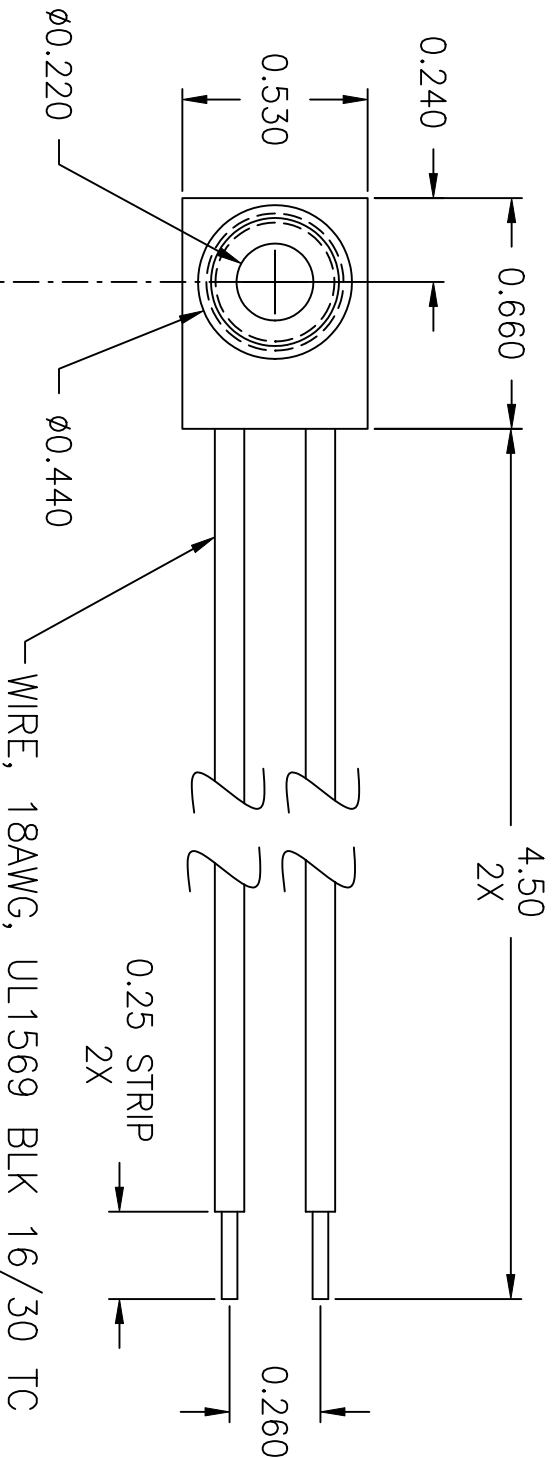

JUDCO INVENTORY NO. 40-3145-01  
 SWITCH TYPE: PUSH ON - PUSH OFF, SPST  
 UL ELECTRICAL RATING: 125VAC, 6A, 6A-L  
 UL TEMPERATURE RATING: 65°C  
 NUTS PACKED SEPARATELY  
 ELECTRICAL GREASE ADDED: SYNTECH 2292G2

CUSTOMER: DIGI KEY  
 CUST. PN: 511 PB-ND  
 APPROVED BY: \_\_\_\_\_  
 DATE: \_\_\_\_\_

DIMENSIONS IN INCHES  
 DIMENSIONS ARE REFERENCE

DRAWN: EM 02-10-04  
 APPR: KJ 02-10-04

TITLE: HARBOR CITY CALIFORNIA  
 OUTLINE: J-188A-1 ULAC  
 DWG. NO.: 1415-569

SHEET: 1 OF 1

This document embodies a product, component, and/or design proprietary to JUDCO MANUFACTURING INC., and which is protected either as a trade secret, by U.S. Patent, or by copyright. It may not be used in any way without written consent of JUDCO MANUFACTURING INC.