

SPRING-LOADED PINS

DISCRETE SPRING-LOADED CONTACTS

0965

0965-0-15-20-80-14-11-0

Ultra low profile, Surface mount
* Stainless steel spring

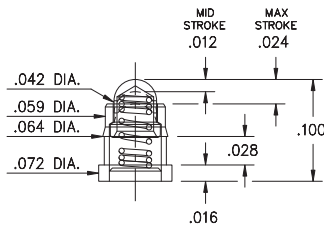

0921-0

0921-0-15-20-76-14-11-0

Ultra low profile, Short stroke. Solder mount in .070 min. mounting hole
Also available on 24mm wide carrier tape: 1,700 parts per 13" reel
Order as: 0921-0-57-20-76-14-11-0

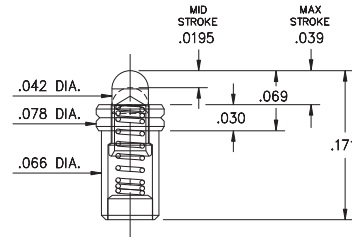

0921-1

0921-1-15-20-7X-14-11-0

Low profile, Standard stroke
Solder mount in .070 min. mounting hole

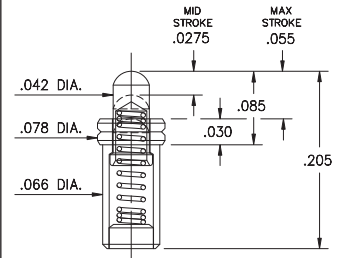

0926-0

0926-0-15-20-76-14-11-0

Low Profile, Short Stroke
Solder mount in .074 min. mounting hole

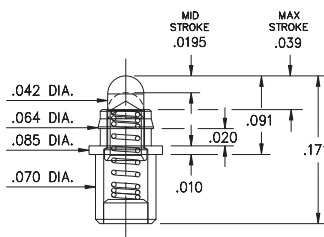

0926-1

0926-1-15-20-75-14-11-0

Low profile, Standard stroke
Solder mount in .074 min. mounting hole

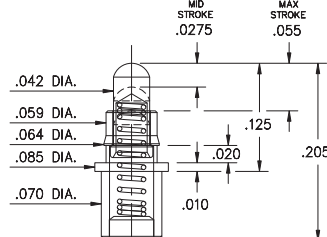

0977

0977-0-15-20-7X-14-11-0

Standard stroke, Surface mount
Also available on 24mm wide carrier tape: 1,100 parts per 13" reel
Order as: 0977-0-57-20-7X-14-11-0

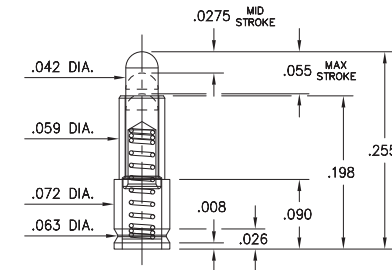

0911

0911-0-15-20-86-14-11-0

Standard stroke, Surface mount
* Stainless steel spring

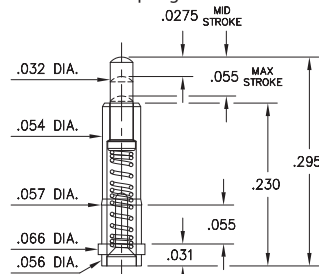

0980

0980-0-15-20-7X-14-11-0

Double action, .055 Combined stroke
Mount between parallel circuit boards

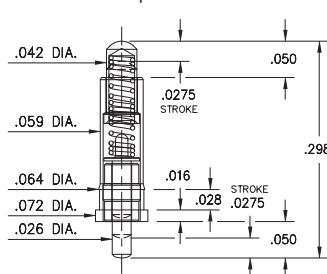

0959

0959-0-54-20-7X-14-11-0

Receptacle spring pin, Standard stroke
Accepts .020" - .032" Dia. pins

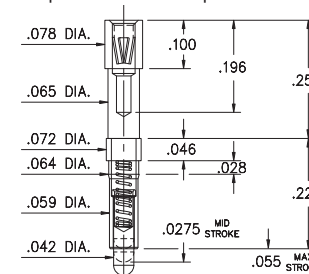

0919

0919-0-15-20-89-14-11-0

3mm (.118") Long stroke, Surface mount
* Stainless steel spring

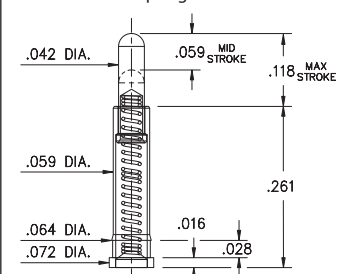

Material Specifications:

Sleeve & Plunger Material: Copper Alloy
Spring Material: BeCu or Stainless Steel 302 *
Sleeve & Plunger Finish: 20 μ" Gold over Nickel
Spring Finish: 10 μ" Gold over Nickel
Dimensions: Inches
Tolerances On: Lengths: ±.006
Diameters: ±.002
Angles: ±2°



Mechanical & Electrical Specifications:

Durability: 1,000,000 cycles
Current Rating: 2A continuous, 3A peak
Contact Resistance: 20 mΩ max.
Environmental Specifications:
Operating temperature range: -55/+125°C

75, 76, 80, 85, 86, 89 Springs are not interchangeable

Order Code: 09XX - X - 15 - 20 - XX - 14 - 11 - 0

Spring Number

| Spring Number | Mid. Stroke | Max. Stroke | Force @ Mid. Stroke | Initial Force (Pre-Load) |
|---------------|-------------|-------------|---------------------|--------------------------|
| 75 | .0275 | .055 | 60 g | 25 g |
| 76 | .0195 | .039 | 60 g | 25 g |
| 80 | .012 | .024 | 70 g | 25 g |
| 85 | .040 | .080 | 60 g | 25 g |
| 86 | .0275 | .055 | 60 g | 25 g |
| 89 | .059 | .118 | 85 g | 25 g |

