

PART NO.	"d2"	"h1"	"d1" NOMINAL DIA.	"h2" ±.039 (±1)	"D"	"d3"
RGS1-60466	.343 (8.7)	.063 (1.6)	.201 (5.1)	1.654 (42.0)	.559 (14.2)	.280 (7.1)

AVAILABLE BY SPECIAL ORDER.

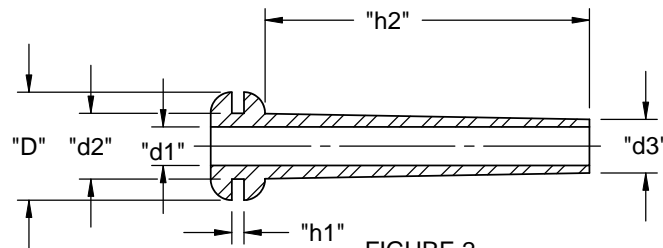
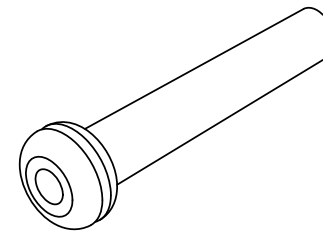

FIGURE 2.



- NOTES:
 1. MATERIAL: PVC (RMS-25)
 2. COLOR: BLACK

REV.	DESCRIPTION	ENGR.	DATE	TITLE: RICHCO GROMMET SLEEVE - TYPE 1	FILE #: RGS1	DWN: S.J.	APP:	DWG IN IN [MM]	FINAL	PRINT TYPE
F	SEE CO 200609 FOR CHANGES	SK	12.16.10	TOLERANCES UNLESS NOTED .XX=±.020 .XXX=±.015 FRAC.=±1/32 ANG.=±1°	SHEET: 1 OF 1	SHEET SIZE: A	DT: 07.15.02	CHKD:	PART #	CA
E	SEE CO 200604 FOR CHANGES	SK	12.01.10		RE: RICHCO, INC.	RICHCO, INC.		ENG@RICHCO-INC.COM	SEE TABLE	
D	CHANGED TOL ON "h2" DIMENSION, CO 200538	SK	06/10/10		RICHCO, INC.		ENG@RICHCO-INC.COM	(773) 539-4060		
C	SEE ECN #1242 FOR CHANGES	SK	10/31/06							
B	SEE ECN #606 FOR CHANGES	SM	03.31.03							
A	SEE ECN #541 FOR CHANGES	SM	12.12.02							