

THIS DRAWING IS UNPUBLISHED.
 © COPYRIGHT BY TYCO ELECTRONICS CORPORATION. ALL RIGHTS RESERVED.

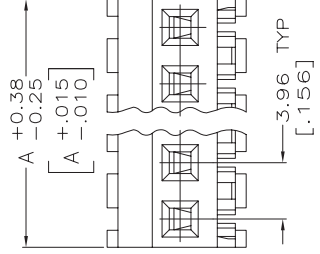

- 1 MATERIAL: CONNECTOR - NYLON UL94V-2 (WHITE). CONTACTS - 0.30[.012] THICK COPPER ALLOY. PLATING - 0.00038[.000015] GOLD IN CONTACT AREA. 0.00203[.000080] MIN THICKNESS BRIGHT TIN-LEAD IN SLOT AREA FOR 641151-2 THRU 2-641151-4 OR MATTE WHISKER MITIGATED TIN IN SLOT AREA FOR 3-641151-2 THRU 5-641151-4 OVER NICKEL UNDERPLATE.
2. CONTACTS ACCEPT 24 AWG WIRE WITH 2.41[.095] MAX INSULATION DIAMETER.
3. CONTACTS MUST ACCEPT 1.14±0.03[.045±.001] SQUARE POST AND REMAIN LOCKED IN POSITION.
- 4 IDENTIFICATION NUMBER FOR LAST CIRCUIT MAY NOT APPEAR ON ALL ASSEMBLIES.
5. DIMENSIONS IN BRACKETS ARE IN INCHES.
6. HOUSING FEATURES ARE: FEED-THRU WITHOUT LOCKING RAMP.

NOTE DELETED.
 NOTE DELETED.

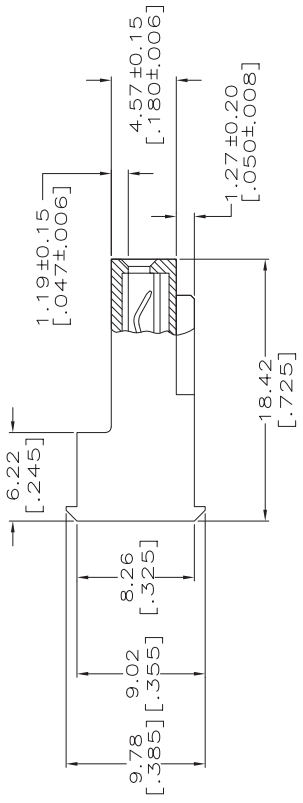
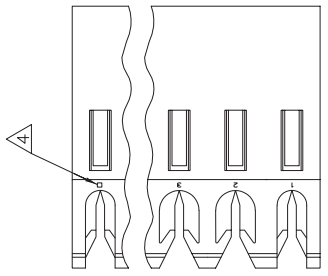

LOC CM O
 P LTR H
 ECO-07-012886

REVISIONS
 DESCRIPTION
 DATE
 22JUN07 KW DB

95.10	3.744	24	5-641176-4
91.14	3.588	23	5-641176-3
87.17	3.432	22	5-641176-2
83.21	3.276	21	5-641176-1
79.25	3.120	20	5-641176-0
75.29	2.964	19	4-641176-9
71.32	2.808	18	4-641176-8
67.36	2.652	17	4-641176-7
63.40	2.496	16	4-641176-6
59.44	2.340	15	4-641176-5
55.47	2.184	14	4-641176-4
51.51	2.028	13	4-641176-3
47.55	1.872	12	4-641176-2
43.59	1.716	11	4-641176-1
39.62	1.560	10	4-641176-0
35.66	1.404	9	3-641176-9
31.70	1.248	8	3-641176-8
27.74	1.092	7	3-641176-7
23.77	.936	6	3-641176-6
19.81	.780	5	3-641176-5
15.85	.624	4	3-641176-4
11.89	.468	3	3-641176-3
7.92	.312	2	3-641176-2
95.10	3.744	24	2-641176-4
91.14	3.588	23	2-641176-3
87.17	3.432	22	2-641176-2
83.21	3.276	21	2-641176-1
79.25	3.120	20	2-641176-0
75.29	2.964	19	1-641176-9
71.32	2.808	18	1-641176-8
67.36	2.652	17	1-641176-7
63.40	2.496	16	1-641176-6
59.44	2.340	15	1-641176-5
55.47	2.184	14	1-641176-4
51.51	2.028	13	1-641176-3
47.55	1.872	12	1-641176-2
43.59	1.716	11	1-641176-1
39.62	1.560	10	1-641176-0
35.66	1.404	9	641176-9
31.70	1.248	8	641176-8
27.74	1.092	7	641176-7
23.77	.936	6	641176-6
19.81	.780	5	641176-5
15.85	.624	4	641176-4
11.89	.468	3	641176-3
7.92	.312	2	641176-2

TIN-LEAD

CONTRACT FINISH DIM A NO. OF CIRCUITS PART NO.

THIS DRAWING IS A CONTROLLED DOCUMENT.
 DWN B. LEWIS 3-11-98 Tyco Electronics Tyco Electronics Corporation
 OK C. SWING 3-11-98 Harrisburg, Pa 17105-3608
 NAME
 PRODUCT SPEC 108-1051
 APPLICATION SPEC 114-1020
 WEIGHT
 FINISH
 MATERIAL - Δ

OTHER DIMENSIONS:
 0 PL ±
 1 PL ±
 2 PL ±
 3 PL ±
 4 PL ±
 5 PL ±
 6 PL ±
 7 PL ±
 8 PL ±
 9 PL ±
 10 PL ±
 11 PL ±
 12 PL ±
 13 PL ±
 14 PL ±
 15 PL ±
 16 PL ±
 17 PL ±
 18 PL ±
 19 PL ±
 20 PL ±
 21 PL ±
 22 PL ±
 23 PL ±
 24 PL ±

SCALE 4:1 SHEET 1 OF 1

RESTRICTED TO