

NOTES:

1. ONLY THE ITEMS WITH QUANTITIES SPECIFIED ON PARTS LIST ARE USED ON THIS APPLICATOR.

▲ USED IN PLACE OF ITEM 38 WHEN INSULATION CRIMP IS NOT USED.

▲ GUARD MUST BE IN PLACE WHEN OPERATING APPLICATOR IN AMP-O-LECTRIC PRESS.

▲ CUT TO LENGTH AT ASSY.

▲ SEE DWGS FOR COMPONENTS.

▲ QTY IN INCHES.

KEY:

■ RECOMMENDED SPARE PARTS.

▲ LUBRICATE DAILY USING NO.20 MACHINE OIL.

▲ GREASE LIGHTLY.

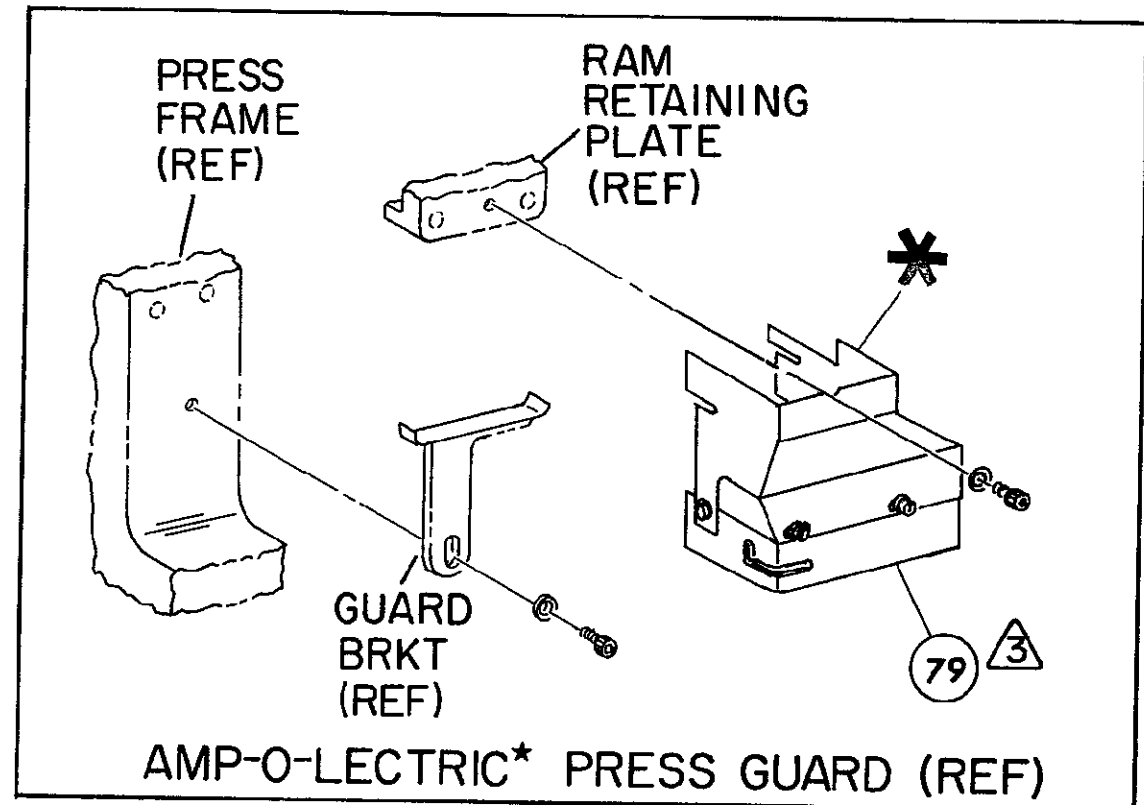

* GENERAL REPRESENTATION ONLY

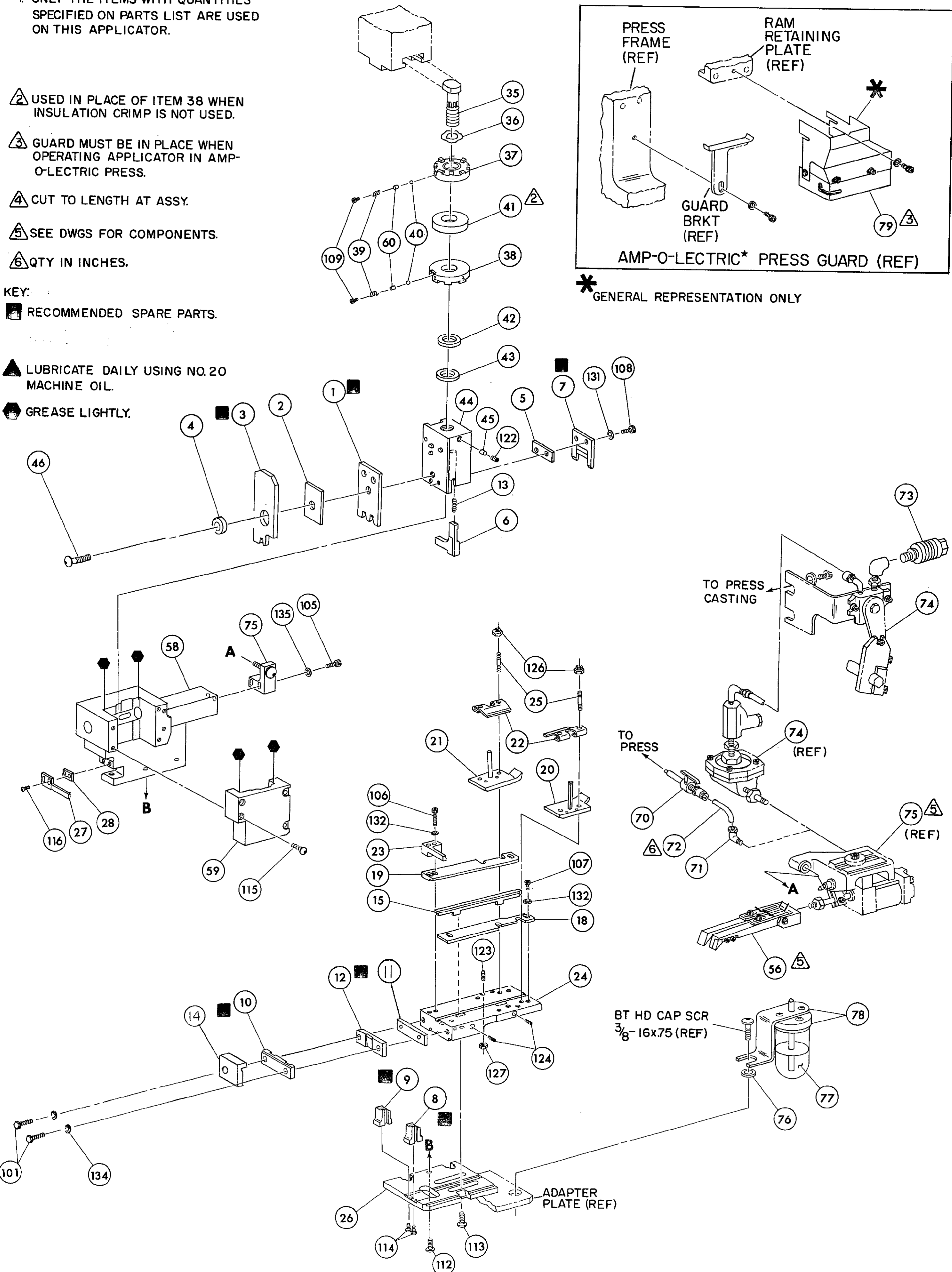

QTY	PART NO	DESCRIPTION	ITEM NO
			145
			144
			143
			142
			141
			140
			139
			138
			137
			136
2	21024-5	WASHER, LOCK (NO 10) AIR FEED ASSY	135
2	21024-5	WASHER, LOCK (NO 10) SHEAR PLATES	134
			133
			132
			131
			130
			129
			128
			127
			126
			125
			124
			123
			122
			121
			120
			119
			118
			117
			116
2	3-22603-4	SCR, BTN HD SKT CAP (8-32 X.75) STRIPPER	115
4	3-21002-1	SCR, BTN HD SKT CAP (10-32 X 1.00) HSG CAP	114
2	22733-8	SCR, BTN HD SKT CAP (8-32 X .38) (LOC-WEL) ANVIL	113
4	3-21002-3	SCR, BTN HD SKT CAP (1/4-20 X .50) STR GDE PL	112
3	2-22733-8	SCR, BTN HD SKT CAP (1/4-20 X .62) BASE PL	111
			110
			109
			108
			107
			106
			105
			104
			103
			102
2	4-21000-0	SCR,SKT. HD CAP (10-32 X1.25) SHEAR PLATE	101
1	455750-6	GUARD ASSY	79
		LUBRICATOR ASSY	78
		OIL, LUBRICATING	77
		SPACER, LUB BRACKET	76
1	460277-3	AIR FEED ASSY	75
1	692655-1	AIR FEED VALVE ASSY-692655-5	74
1	24042-2	VALVE, SHUT-OFF	73
1	22620-1	TUBING, PLASTIC	72
1	22294-6	ELBOW, PLASTIC TUBING	71
		INSERT, COUPLING	70
			69
			68
			67
			66
			65
			64
			63
			62
			61
			60
			59
			58
			57
			56
			55
			54
			53
			52
			51
			50
			49
			48
			47
			46
			45
			44
			43
			42
			41
			40
			39
			38
			37
			36
			35
			34
			33
			32
			31
			30
			29
			28
			27
			26
			25
			24
			23
			22
			21
			20
			19
			18
			17
			16
			15
			14
			13
			12
			11
			10
			9
			8
			7
			6
			5
			4
			3
			2
			1

REMARKS		NO	REV
APPL USED ON MACHINE PART NO		MACH SERIAL NO	DISTRIBUTION
CUSTOMER NAME		APPL SERIAL NO	ORIGINAL
ADDRESS		PURCHASE ORDER	CUSTOMER COPY
CITY		ENG APP	FIELD ENG COPY

CRIMPING DATA						APPLICATOR WILL APPLY	
PAD	CRIMP HEIGHT	WIRE SIZE	WIRE RANGE	LEFT	RIGHT	LEFT	RIGHT
LTR	LEFT RIGHT	LEFT RIGHT	LEFT RIGHT	LEFT	RIGHT	22-18	60325-2 62835-1
A	.048 .062	18 18	RIGHT	22-18			
B	.045 .059	20 20	INSUL RANGE				
C	.042 .056	22 22	LEFT	RIGHT	.125-.165		
D	NOT USED		RIGHT				
CRIMP	SIZE	TYPE	CRIMP	SIZE	TYPE	FEED	
WIRE	LEFT	.090 F	INSUL	LEFT	.180 O	LEFT	.765
	RIGHT	.100 F	INSUL	RIGHT		RIGHT	.897
PRESS REF	APPL INST AT		8046				
REMARKS							
AMP O LECTRIC DUAL							

REV	DATE	DESCRIPTION
1	10-1-88	DR 4-14-89 APP
2	10-1-88	DR 4-14-89 APP
3	10-1-88	DR 4-14-89 APP
4	10-1-88	DR 4-14-89 APP
5	10-1-88	DR 4-14-89 APP
6	10-1-88	DR 4-14-89 APP
7	10-1-88	DR 4-14-89 APP
8	10-1-88	DR 4-14-89 APP
9	10-1-88	DR 4-14-89 APP
10	10-1-88	DR 4-14-89 APP
11	10-1-88	DR 4-14-89 APP
12	10-1-88	DR 4-14-89 APP
13	10-1-88	DR 4-14-89 APP
14	10-1-88	DR 4-14-89 APP
15	10-1-88	DR 4-14-89 APP
16	10-1-88	DR 4-14-89 APP
17	10-1-88	DR 4-14-89 APP
18	10-1-88	DR 4-14-89 APP
19	10-1-88	DR 4-14-89 APP
20	10-1-88	DR 4-14-89 APP
21	10-1-88	DR 4-14-89 APP
22	10-1-88	DR 4-14-89 APP
23	10-1-88	DR 4-14-89 APP
24	10-1-88	DR 4-14-89 APP
25	10-1-88	DR 4-14-89 APP
26	10-1-88	DR 4-14-89 APP
27	10-1-88	DR 4-14-89 APP
28	10-1-88	DR 4-14-89 APP
29	10-1-88	DR 4-14-89 APP
30	10-1-88	DR 4-14-89 APP
31	10-1-88	DR 4-14-89 APP
32	10-1-88	DR 4-14-89 APP
33	10-1-88	DR 4-14-89 APP
34	10-1-88	DR 4-14-89 APP
35	10-1-88	DR 4-14-89 APP
36	10-1-88	DR 4-14-89 APP
37	10-1-88	DR 4-14-89 APP
38	10-1-88	DR 4-14-89 APP
39	10-1-88	DR 4-14-89 APP
40	10-1-88	DR 4-14-89 APP
41	10-1-88	DR 4-14-89 APP
42	10-1-88	DR 4-14-89 APP
43	10-1-88	DR 4-14-89 APP
44	10-1-88	DR 4-14-89 APP
45	10-1-88	DR 4-14-89 APP
46	10-1-88	DR 4-14-89 APP
47	10-1-88	DR 4-14-89 APP
48	10-1-88	DR 4-14-89 APP
49	10-1-88	DR 4-14-89 APP
50	10-1-88	DR 4-14-89 APP
51	10-1-88	DR 4-14-89 APP
52	10-1-88	DR 4-14-89 APP
53	10-1-88	DR 4-14-89 APP
54	10-1-88	DR 4-14-89 APP
55	10-1-88	DR 4-14-89 APP
56	10-1-88	DR 4-14-89 APP
57	10-1-88	DR 4-14-89 APP
58	10-1-88	DR 4-14-89 APP
59	10-1-88	DR 4-14-89 APP
60	10-1-88	DR 4-14-89 APP
61	10-1-88	DR 4-14-89 APP
62	10-1-88	DR 4-14-89 APP
63	10-1-88	DR 4-14-89 APP
64	10-1-88	DR 4-14-89 APP
65	10-1-88	DR 4-14-89 APP
66	10-1-88	DR 4-14-89 APP
67	10-1-88	DR 4-14-89 APP
68	10-1-88	DR 4-14-89 APP
69	10-1-88	DR 4-14-89 APP
70	10-1-88	DR 4-14-89 APP
71	10-1-88	DR 4-14-89 APP
72	10-1-88	DR 4-14-89 APP
73	10-1-88	DR 4-14-89 APP
74	10-1-88	DR 4-14-89 APP
75	10-1-88	DR 4-14-89 APP
76	10-1-88	DR 4-14-89 APP
77	10-1-88	DR 4-14-89 APP
78	10-1-88	DR 4-14-89 APP
79	10-1-88	DR 4-14-89 APP
80	10-1-88	DR 4-14-89 APP
81	10-1-88	DR 4-14-89 APP
82	10-1-88	DR 4-14-89 APP
83	10-1-88	DR 4-14-89 APP
84	10-1-88	DR 4-14-89 APP
85	10-1-88	DR 4-14-89 APP
86	10-1-88	DR 4-14-89 APP
87	10-1-88	DR 4-14-89 APP
88	10-1-88	DR 4-14-89 APP
89	10-1-88	DR 4-14-89 APP
90	10-1-88	DR 4-14-89 APP
91	10-1-88	DR 4-14-89 APP
92	10-1-88	DR 4-14-89 APP
93	10-1-88	DR 4-14-89 APP
94	10-1-88	DR 4-14-89 APP
95	10-1-88	DR 4-14-89 APP
96	10-1-88	DR 4-14-89 APP
97	10-1-88	DR 4-14-89 APP
98	10-1-88	DR 4-14-89 APP
99	10-1-88	DR 4-14-89 APP
100	10-1-88	DR 4-14-89 APP

THIS DRAWING IS A CONTROLLED DOCUMENT FOR AMP INC. IT IS SUBJECT TO CHANGE AND THE USER SHOULD BE CONTACTED FOR THE LATEST REVISION.

THIS INFORMATION IS CONFIDENTIAL AND IS DISCLOSED TO YOU ON CONDITION THAT NO FURTHER DISCLOSURE IS MADE BY YOU TO OTHER THAN AMP PERSONNEL WITHOUT WRITTEN AUTHORIZATION FROM AMP INCORPORATED, HARRISBURG, PA.

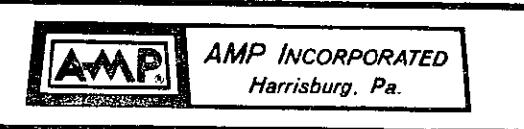

LOC A D NO 567328-2 REV 10

MINIATURE QUICK CHANGE APPLICATOR END FEED, DUAL (AMPLVAR RING)