

FACE VIEW OF END RECEPTACLE

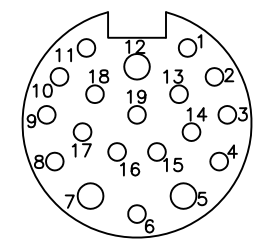

NOTE  
PINS 1,2,9,10,11,13,17,18 NOT USED

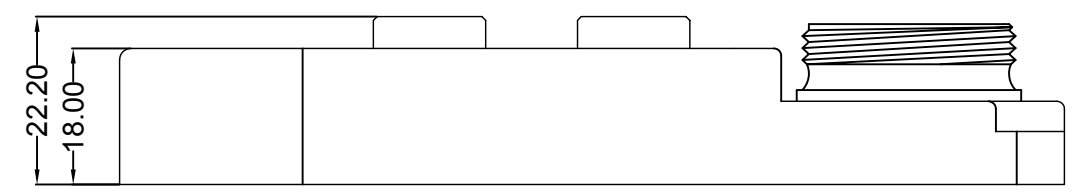

MATERIAL NUMBER	OLD PART NUMBER	FINISHED LENGTH	CABLE JACKET MATERIAL
1201140035	BTY4030-FBB	-	-

VOLTAGE RATING	10-30 VDC
AMPERAGE RATING PER PORT	4 AMPS
PROTECTION	IP67
OPERATING TEMPERATURE	-20°C TO 90°C
UL CERTIFICATIONS	UL RECOGNIZED, FILE NO. E46237
CSA CERTIFICATIONS	CSA CERTIFIED, FILE NO. LR6837

ITEM	COMPONENT	MATERIAL	FINISH
1	INSERT	NYLON	BLACK
2	CONTACT SOCKET	COPPER ALLOY	GOLD OVER NICKEL
3	O-RING	NITRILE	RED
4	RECEPTACLE SHELL	BRASS	NICKEL PLATED
5	HOUSING	PBT	YELLOW
6	LABEL	ABS	WHITE

DESCRIPTION EC NO: WEU2010-0423 DRWN: LSTEMMLE 2010/03/10 CHKD: NSTAUDIG APPR: NSTAUDIG 2010/03/16	QUALITY SYMBOLS	GENERAL TOLERANCES (UNLESS SPECIFIED) mm INCH 4 PLACES ±--- ±--- 3 PLACES ±--- ±--- 2 PLACES ±--- ±.01 1 PLACE ±0.3 ±--- ANGULAR ± --- °	DIMENSION STYLE	SCALE	DESIGN UNITS	THIRD ANGLE PROJECTION MICRO-CHANGE MPIS 4 PORT TOP MOUNT MINI-CHANGE MOLEX INCORPORATED SD-120114-023 1 OF 1
	▼ = 0 ▽ = 0		MM ONLY	2:1	METRIC	
	DRAWN BY DATE LSTEMMLE 2010/03/10 CHECKED BY DATE FP 2010/03/10 APPROVED BY DATE NSTAUDIG 2010/03/15		SEE TABLE THIS DRAWING CONTAINS INFORMATION THAT IS PROPRIETARY TO MOLEX INCORPORATED AND SHOULD NOT BE USED WITHOUT WRITTEN PERMISSION	DOCUMENT NO.	SHEET NO.	
	DRAFT WHERE APPLICABLE MUST REMAIN WITHIN DIMENSIONS		SIZE			