

ISOMETRIC

Parts List			
ITEM	QTY	PART NUMBER	DESCRIPTION
1	1	F060614	LASEEU11
2	1	F051701	29MM RING FOR LA SERIES GRAY
3	1	F060250	29MM LA U1 NUT
4	1	F060298	29MM YELLOW LENS OPAQUE
5	1	F050405	50-004-05 28V AC/DC 40mA INCANDESCENT

▲ YELLOW LENS ASSY (OPAQUE)

4

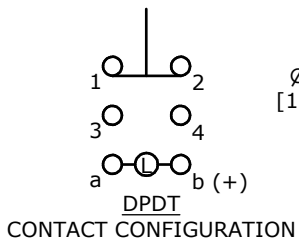

▲ $\varnothing 29.00$ [1.142 in]

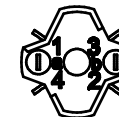
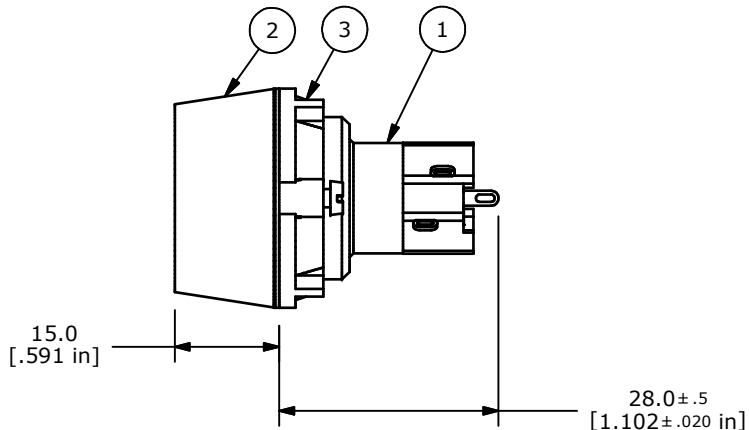
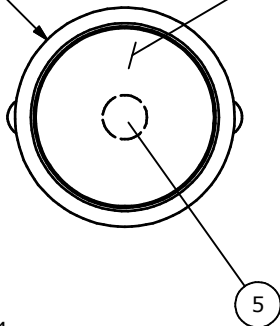

- NOTE:
1. ALL DIMENSIONS IN MM [INCH]
 2. GENERAL TOLERANCE: X.X=±0.4
X.XX=±0.25
 3. TERMINAL NUMBERS FOR REF ONLY
 4. RATING: 5 AMPS @ 250VAC UL, VDE APPROVED
6 AMPS @ 24VDC UL, VDE APPROVED
 5. ELECTRIC LIFE: 50,000 MAKE-AND-BREAK CYCLES AT FULL LOAD.
 6. INSULATION RESISTANCE: 1,000 MEGA-OHM MIN.
 7. SEAL RATING: IP 65
 8. (MOUNTING) PANEL THICKNESS: 0.5 - 4.0 mm
 9. OPERATING TEMP.: -25°C to 55°C
 - ▲ 10. LAMP VOLTAGE: 28V AC/DC 40mA INCANDESCENT BULB
 11. ▲ DENOTES CRITICAL PARAMETER.
 12. 2002/95/EC (ROHS) COMPLIANT



A	18396	RELEASED FOR PRODUCTION	2/12/09	BLR
REV	PCR NO	DESCRIPTION	DATE	BY

TITLE LASEEU11CYEL

THE INFORMATION CONTAINED IN THIS DOCUMENT IS PROPRIETARY TO E-SWITCH AND IS NOT TO BE COPIED OR TRANSFERRED

SCALE	DATE	DR	DWG	REV
1:1	2/12/2009	BLR	XF0783P	A