

THIS DRAWING IS UNPUBLISHED. RELEASED FOR PUBLICATION
 © COPYRIGHT BY TYCO ELECTRONICS CORPORATION. ALL INTERNATIONAL RIGHTS RESERVED.

LOC	DIST	REVISIONS					
		P	LTR	DESCRIPTION	DATE	DWN	APVD
—	—		G1	REVISED PER ECO-09-009918	4/23/09	SS	PD

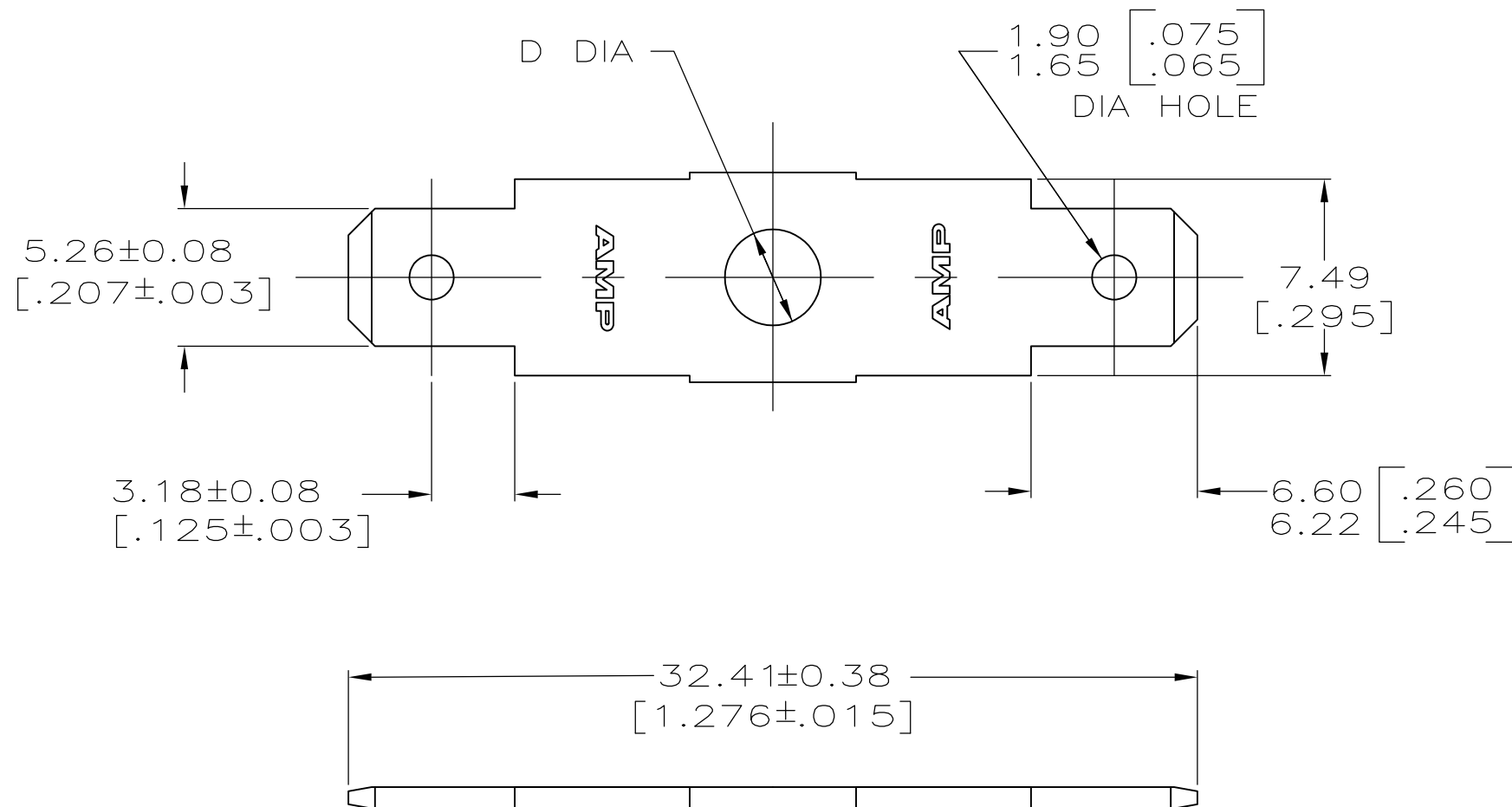

1 SUPPLIED IN LOOSE PIECE.
 2 ELECTRICAL TEST TAB ONLY.

	3.68 [.145]	6	0.002032 [.000080] MIN TIN	0.813±0.012 [.032±.0005] CR STEEL	60922-5 ²
	3.68 [.145]	6	0.002032 [.000080] MIN TIN	0.813±0.025 [.032±.001] BRASS	60922-4
OBSOLETE	5.00 [.197]	10	—	0.813±0.025 [.032±.001] BRASS	60922-3
	4.34 [.171]	8	—	0.813±0.025 [.032±.001] BRASS	60922-2
	3.68 [.145]	6	—	0.813±0.007 [.032±.0003] BRASS	60922-1
	$D^{+0.076}$ DIA [.003]	STUD #	FINISH	MATERIAL	PART NO.

THIS DRAWING IS A CONTROLLED DOCUMENT.		DWN	JR RUTH	8/6/96	Tyco Electronics Corporation Harrisburg, PA 17105-3608
DIMENSIONS: mm [INCHES]		CHK	MS FEHER	8/6/96	
		APVD	P DESANTIS	8/6/96	
TOLERANCES UNLESS OTHERWISE SPECIFIED:		PRODUCT SPEC		NAME	
0 PLC ± -		—		TAB, FASTON, 5.21 [.205] SERIES	
1 PLC ± -		—		—	
2 PLC ± 0.25 [.010]		APPLICATION SPEC		—	
3 PLC ± -		—		—	
4 PLC ± -		—		—	
ANGLES ± -		WEIGHT		—	
MATERIAL SEE TABLE		FINISH SEE TABLE		RESTRICTED TO	
		CUSTOMER DRAWING		—	
		SCALE		4:1	
		SHEET		1 OF 1	
		REV		G1	
		DRAWING NO		A3 00779 C-60922	