

LOC		DIST		REVISED PER		EC		DESCRIPTION		DATE	APPD
CM	54	P	F	C	REVISED PER EC	063B-0664-01				03-DEC-01	KW DB

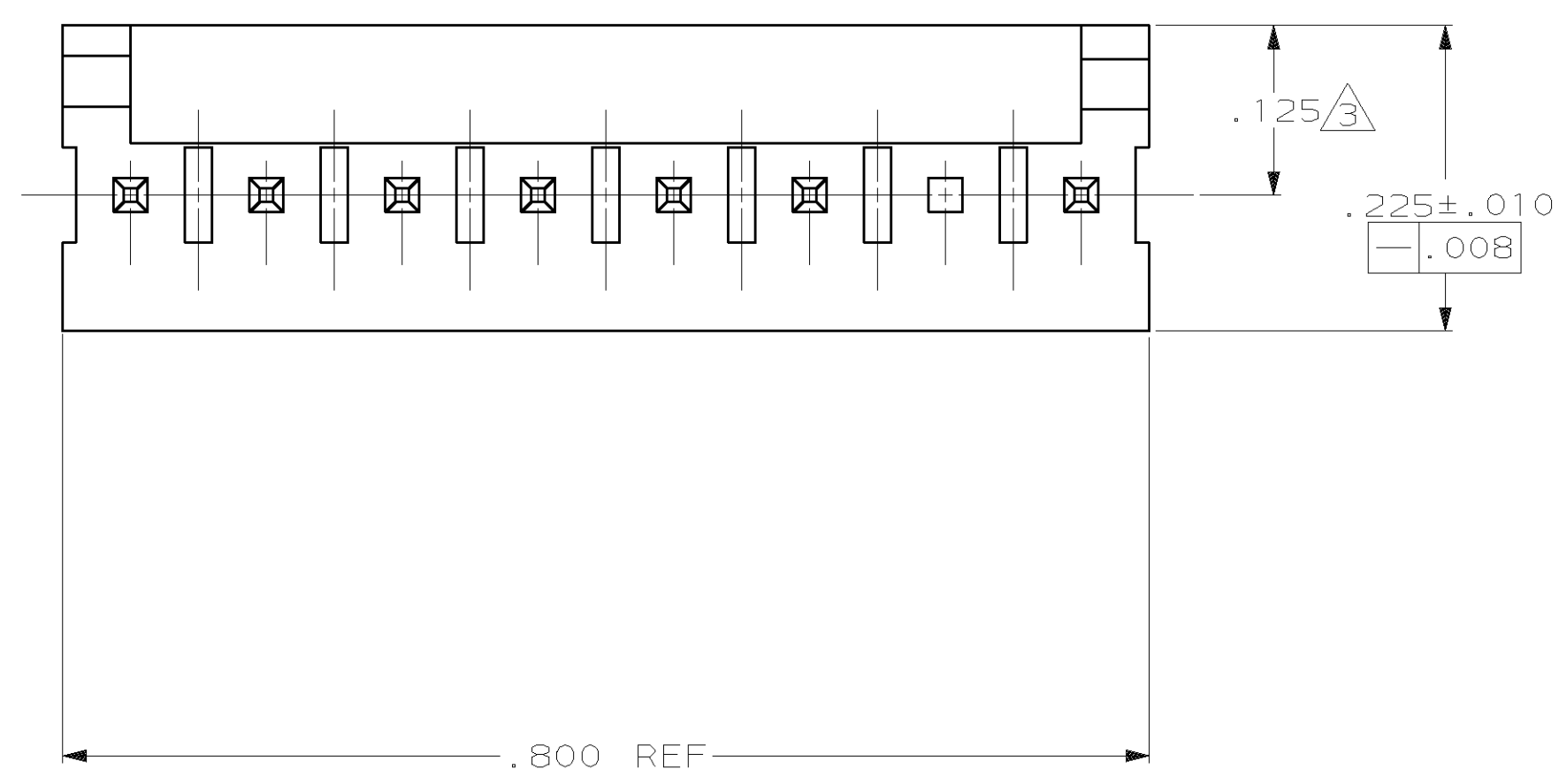

- 1 POST TO WITHSTAND 13 NEWTONS (3LBS.) MIN. AXIAL FORCE IN BOTH DIRECTIONS SHOWN WITHOUT DISLODGING.
- 2 TOLERANCES APPLY TO SOLDER SIDE OF BOARD.
- 3 MEASURED AT SURFACE -A-
- 4 PLASTIC FLASH PERMITTED IN THIS AREA.
- 5 PARTS COMPLY WITH AMP SOLDERABILITY SPEC. NO. 109-11-2.
- 6 ONE HOLE MAY BE UNDERSIZED (.035/.032 DIA.) FOR ASSEMBLY RETENTION DURING WAVE SOLDERING.
- 7 MATERIAL: HEADER-THERMOPLASTIC POLYESTER 94V-0 (NATURAL) POST-COPPER ALLOY (TIN PLATED)
- 8 COORDINATE DIMENSION APPLIES FROM CENTER OF ACTUAL FEATURE.
- 9 PLASTIC BURRS CAUSED BY CUT-OFF TOOLING ARE PERMITTED WITHIN THE MAXIMUM TOLERANCE ENVELOPE.
- 10 POST TO BE MEASURED WHEN STRIP IS HELD FLAT.
- 11 POST MUST WITHSTAND TWO 90° BENDS AGAINST EXTRUSION WITHOUT BREAKING.
- 12 DIMENSION SHOULD BE .130 MIN WHEN MATING WITH A MTA 100 CONNECTOR ASSEMBLY OR WHEN MATING WITH A CST 100 CONNECTOR.
- 13 PIN BURR OF .005 MAX VERTICAL AND .003 MAX HORIZONTAL PERMITTED AT POST TIPS ON BOTH ENDS.
- 14 COLOR STRIPE BLACK IN APPROXIMATE LOCATION SHOWN.

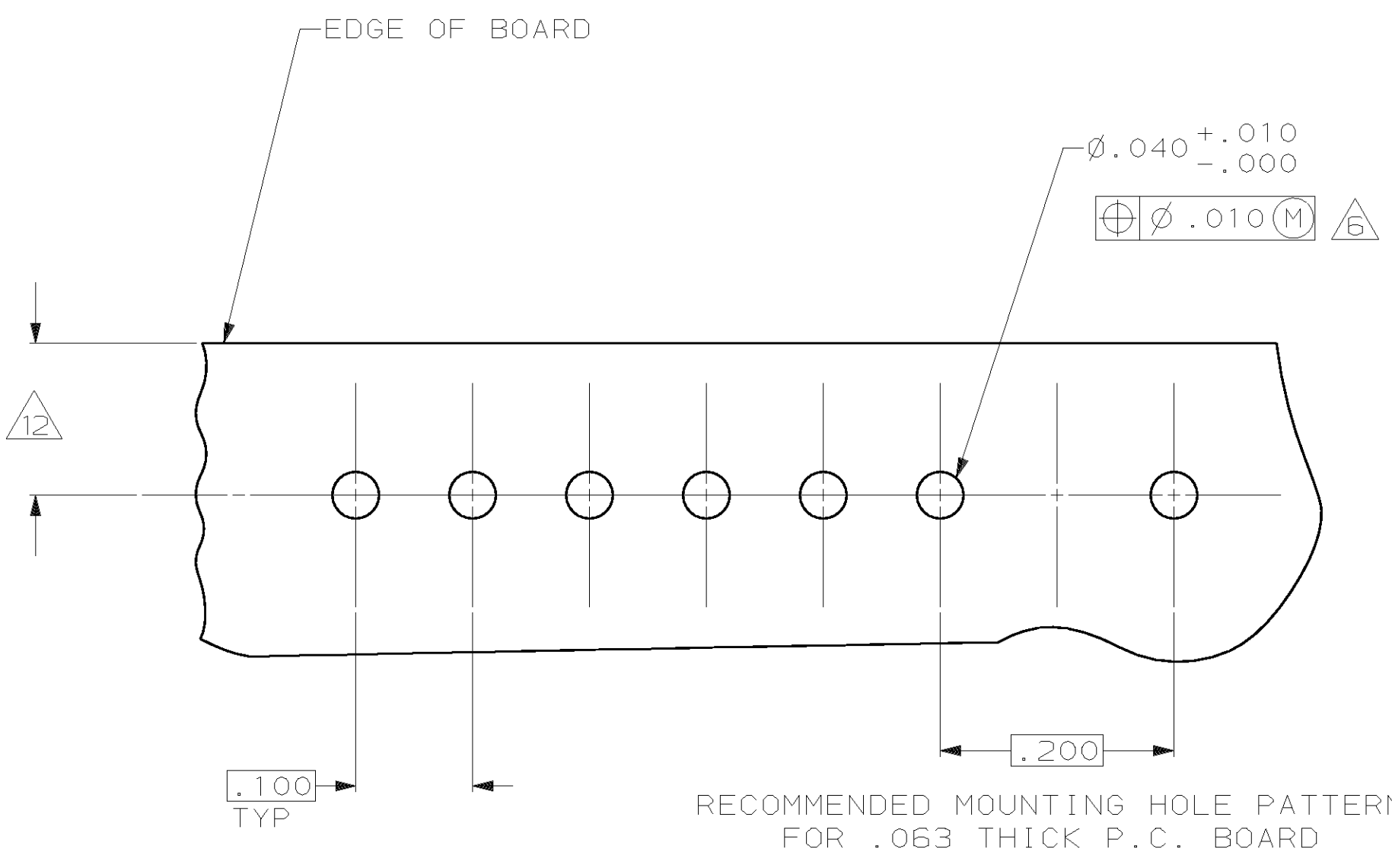
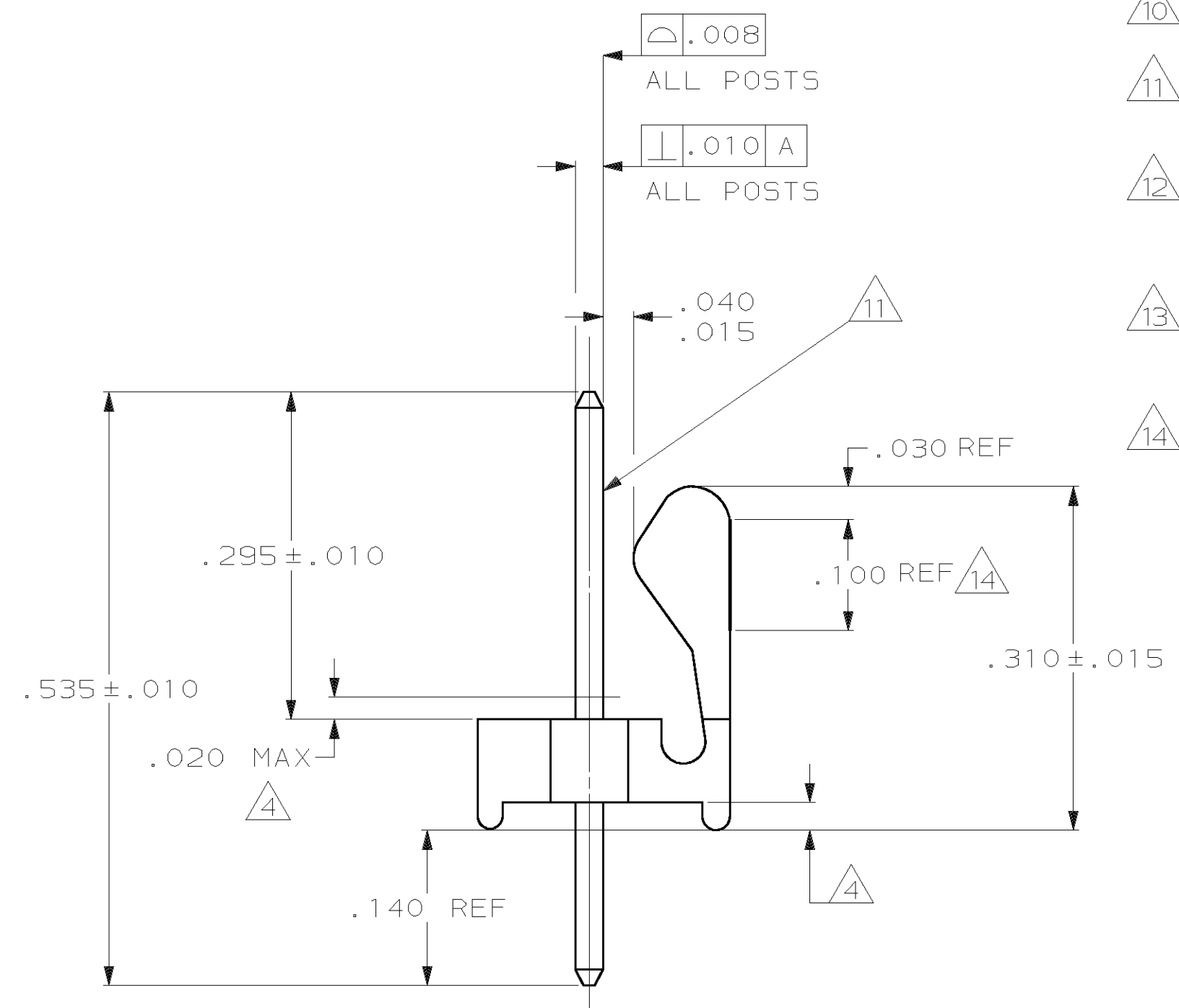
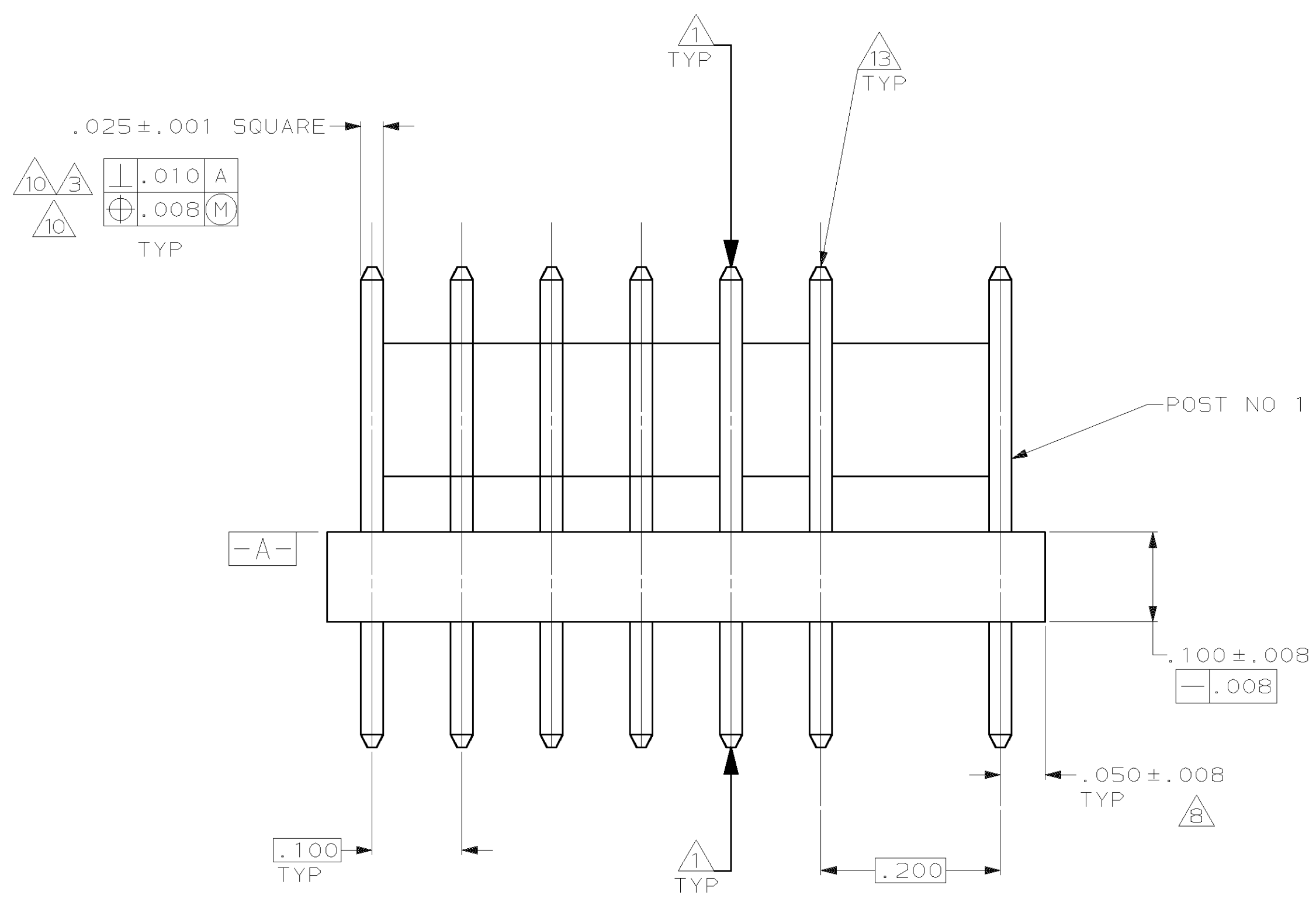

IN	MM	IN	MM
.050	1.27	-	-
.040	1.02	.800	20.32
.035	0.89	.535	13.59
.032	0.81	.310	7.87
.030	0.76	.295	7.49
.025	0.64	.225	5.72
.020	0.51	.200	5.08
.015	0.38	.150	3.81
.010	0.25	.140	3.56
.008	0.20	.130	3.30
.005	0.13	.125	3.18
.003	0.08	.100	2.54
.001	0.03	.063	1.60

METRIC

THIS DRAWING IS A CONTROLLED DOCUMENT FOR AMP INCORPORATED. IT IS SUBJECT TO CHANGE AND THE CONTROLLING ENGINEERING ORGANIZATION SHOULD BE CONTACTED FOR THE LATEST REVISION.

DO NOT SCALE PRINT. UNLESS SPECIFIED DIMENSIONS IN mm [INCHES] TOLERANCES ON:		DR 1-11-95 B. LEWIS	AMP Incorporated Harrisburg, PA 17105-3608
2 PLC DEC ±		CHK 1-11-95 R. SWING	
3 PLC DEC ± .005 ANGLES ± 0°30'		APPD 1-25-95 B. GENTRY	NAME MTA-100 HEADER ASSEMBLY, FRICTION LOCK, NOTCHED, .025 SQUARE STRAIGHT POST, TIN PLATED, 8 POSITION, OMITTED POST
MATERIAL		APPD 1-25-95 B. GENTRY	
FINISH		PRODUCT SPEC	SIZE D
		APPLICATION SPEC	CAGE CODE 00779
		WEIGHT	DRAWING NO. C-644832
			SCALE 8:1
			SHEET 1 OF 1