

LENGTH TABLE

MATERIAL NO.	NO. CIRCUITS	"B"	"A"
394250002	02	12.0 (.472)	28.2 (1.11)
394250003	03	24.0 (.945)	40.2 (1.58)
394250004	04	36.0 (1.417)	52.2 (2.06)
394250005	05	48.0 (1.890)	64.2 (2.53)
394250006	06	60.0 (2.362)	76.2 (3.00)
394250007	07	72.0 (2.835)	88.2 (3.47)
394250008	08	84.0 (3.307)	100.2 (3.95)
394250009	09	96.0 (3.780)	112.2 (4.42)
394250010	10	108.0 (4.252)	124.2 (4.89)

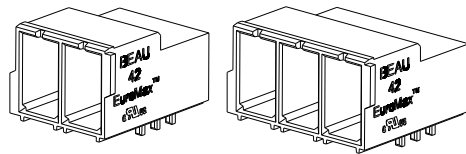

2 AND 3 CIRCUIT HEADERS HAVE NO "PRY SLOTS"

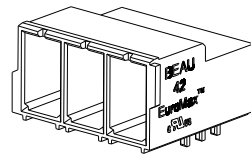

4 CIRCUIT HEADER HAS ONLY ONE "PRY SLOT"

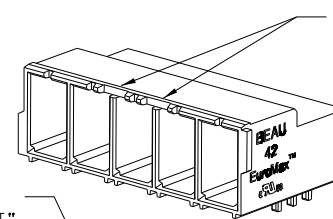

5 THRU 10 CIRCUIT HEADERS HAVE TWO "PRY SLOTS"

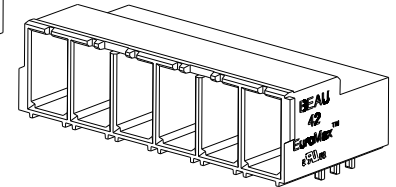

E

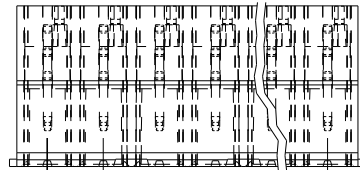

RECOMMENDED PTH PATTERN

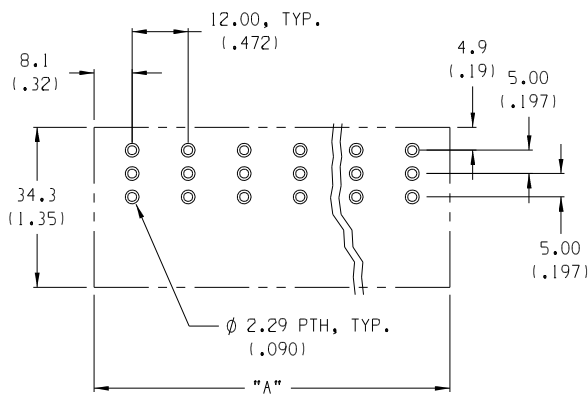

- NOTES:
1. MATERIAL: SEE TABLE
 2. FINISHES: SEE TABLE
 3. PRODUCT SPECIFICATION: SEE PPS.42.001
 4. PACKAGING: NOT REQUIRED
 5. MATES WITH: 3942100XX PLUG
 6. XX EQUALS NUMBER OF CIRCUITS

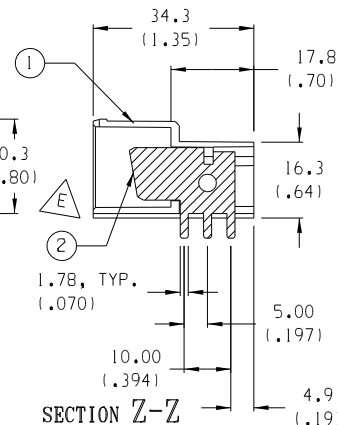
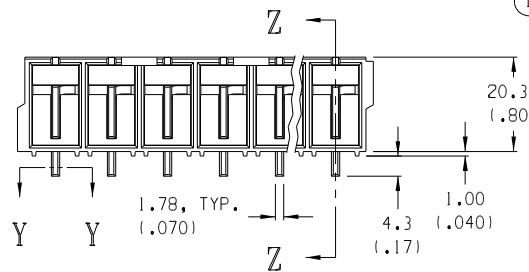

SECTION Y-Y SCALE 3:1

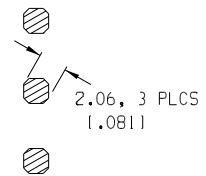

A

ITEM	QTY.	DESCRIPTION	MATERIAL	FINISH
2	XX	BLADE CONTACT	COPPER	TIN
1	1	MOLDING, HEADER	PBT	BLACK

EC NO. 11610	DRWNS: RK 12-1-04	QUALITY SYMBOLS
CH*K	APPR:	MAJOR
REV	DESCRIPTION	CRITICAL
		SPC
		S

GENERAL TOLERANCES: (UNLESS SPECIFIED)		SCALE 1:1	DESIGN UNITS
4 PLACES	±.0015	<input type="checkbox"/> mm	<input checked="" type="checkbox"/> INCH
3 PLACES	±.038	DRAWN BY & DATE	
2 PLACES	±.13	GHR 5-14-2003	
1 PLACE	±.3	CHECKED BY & DATE	
ANGULAR: ±2°		R. KEMP 8-8-03	
DRAFT WHERE APPLICABLE MUST REMAIN WITHIN DIMENSIONS		APPROVED BY & DATE	
		G. ROBERTSON 8-8-03	
		CAD FILENAME	MATERIAL NO.
		4219XX	SEE CHART

THIRD ANGLE PROJECTION	TITLE:
	HEADER, 12MM, 85A, 600V,
MOLEX INCORPORATED	
DRAWING NO.	SHEET NO.
SD-39425-001	1 OF 1

PROJECT NO. 03-65	SHT	REV
DIMENSIONS:		
<input checked="" type="checkbox"/> mm	<input type="checkbox"/> INCH	<input type="checkbox"/> mm ONLY
	REVISE ON CAD ONLY	
THIS DRAWING CONTAINS INFORMATION THAT IS PROPRIETARY TO MOLEX INCORPORATED AND SHOULD NOT BE USED WITHOUT WRITTEN PERMISSION.		
SIZE	B	