

REVISED IEC NO: S2014-0060 DRWN:SKANG 2013/07/19 CH'KD:MLONG 2013/09/06 APPR:MLONG 2013/09/08	QUALITY SYMBOLS	GENERAL TOLERANCES (UNLESS SPECIFIED)		DIMENSION STYLE MM/IN		SCALE NTS	DESIGN UNITS METRIC	THIRD ANGLE PROJECTION	
	$\nabla_F = 0$ $\nabla_E = 0$ $\nabla_A = 0$	4 PLACES	mm	INCH	DRAWN BY VLNRAO	DATE 2004/07/07	TITLE POWER CONN. RECEPTACLE P(A)-S CONFIGURATION VERTICAL PRESS-FIT		
		3 PLACES	± ---	± ---	CHECKED BY BHLOW	DATE 2004/07/15	molex DOCUMENT NO. SD-87925-001 SHEET NO. 1 OF 2		
		2 PLACES	± 0.13	± ---	APPROVED BY SCLOW	DATE 2004/07/20			
	1 PLACE	± 0.25	± ---	MATERIAL NO.		SEE TABLE			
	0 PLACE	±	±	ANGULAR ± 3°		THIS DRAWING CONTAINS INFORMATION THAT IS PROPRIETARY TO MOLEX INCORPORATED AND SHOULD NOT BE USED WITHOUT WRITTEN PERMISSION			
		DRAFT WHERE APPLICABLE MUST REMAIN WITHIN DIMENSIONS							

10	9		8	7	6	5	4	3	2	1
PART NUMBER	P-S CONFIGURATION		RECESSED POWER CIRCUIT	PACKAGING						
	SIGNAL	POWER(ALPHA)								
87925-3000	24	9	ALL EXCEPT A7	TRAY						

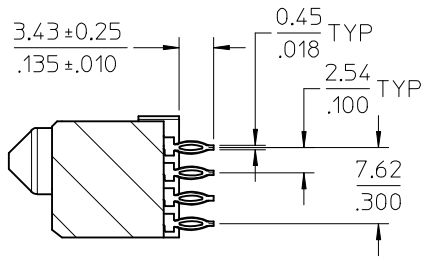

SECTION B-B

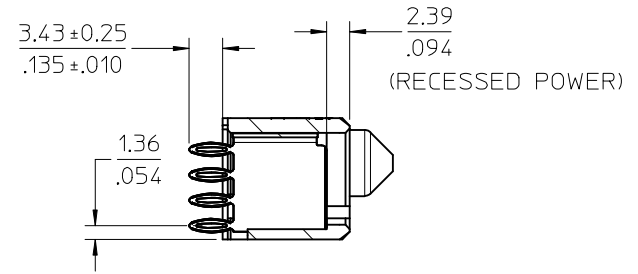

SECTION C-C

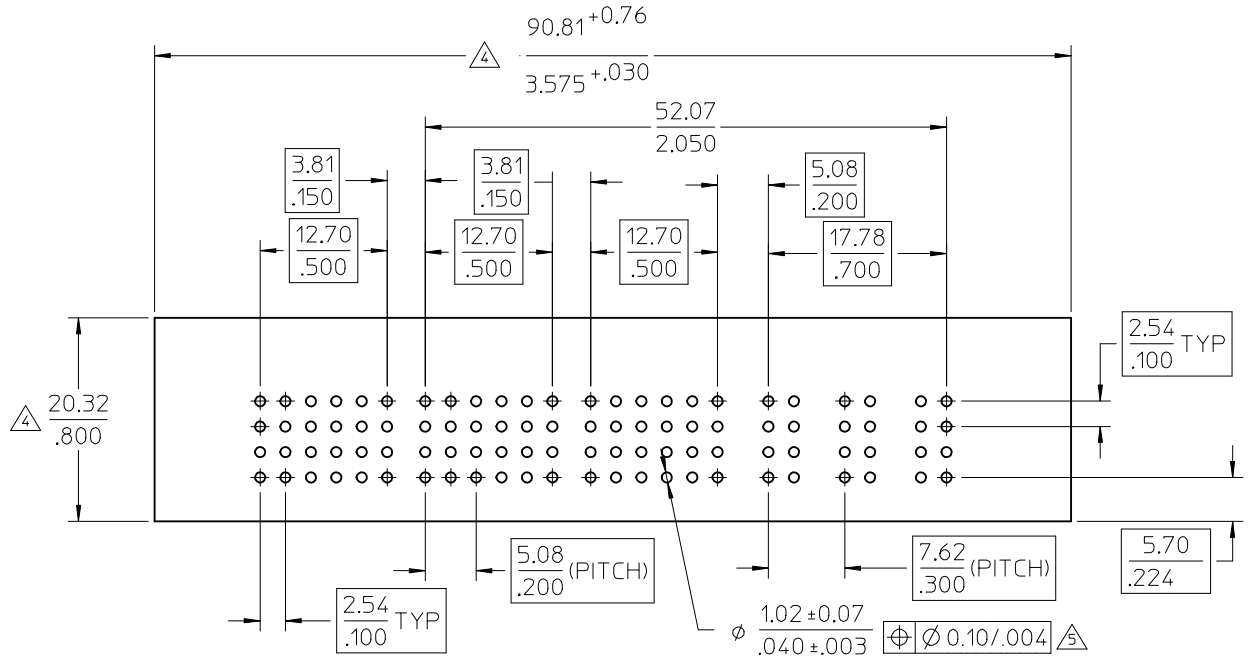

CONNECTOR - NOTES

1. MATERIALS :

- HOUSING - HIGH TEMPERATURE THERMO-PLASTIC, GLASS FILLED, UL94-0,COLOR:BLACK.
- SIGNAL PIN - COPPER ALLOY
- POWER PIN - COPPER ALLOY

2. FINISH :

- SIGNAL & POWER CONTACTS
- 0.76 MICROMETER MINIMUM GOLD (Au) AT CONTACT AREA AND 2.54 MICROMETER MINIMUM TIN AT SOLDER TAIL AREA OVER 1.27um MIN. NICKEL (Ni) UNDERPLATE.

3. PRODUCT SPECIFICATION: PS-87633-006.

- 4. COMPONENT STAY AWAY ZONE FROM CONNECTOR.
- 5. PCB NOTE FOR DIAMETER 1.02/.040 PLATED HOLE.
 - DRILLED HOLE SIZE IS 1.151/.0453
 - PLATE WITH 0.0077/.0003 MINIMUM TIN OVER 0.03/.001 TO 0.08/.003 COPPER PLATING TO ACHIEVE 1.02±0.08/.040±.003 HOLE.
 - SEE SHEET 2 FOR RECOMMENDED PCB LAYOUT.
- 6. MANUFACTURER LOGO,PART NUMBER AND YEAR-WEEK CODE.

REVISED EC NO: S2014-0060 DRWN:SKANG 2013/07/19 CHKD:MLONG 2013/09/06 APPR:MLONG 2013/09/09	DESCRIPTION REV	QUALITY SYMBOLS	GENERAL TOLERANCES (UNLESS SPECIFIED)		DIMENSION STYLE	SCALE	DESIGN UNITS	THIRD ANGLE PROJECTION	
		$\nabla F=0$	mm	INCH	MM/IN	NTS	METRIC		
		$\nabla F=0$	4 PLACES ± --- ± ---	3 PLACES ± --- ± ---	2 PLACES ± 0.13 ± ---	1 PLACE ± 0.25 ± ---	0 PLACE ± ±	TITLE	
		$\nabla F=0$	ANGULAR ± 3 °		DRAWN BY VLNRAO DATE 2004/07/07		CHECKED BY BHL0W DATE 2004/07/15		POWER CONN. RECEPTACLE P(A)-S CONFIGURATION VERTICAL PRESS-FIT
DRAFT WHERE APPLICABLE MUST REMAIN WITHIN DIMENSIONS		APPROVED BY SCL0W DATE 2004/07/20		MATERIAL NO. SEE TABLE		DOCUMENT NO. SD-87925-001			
				SIZE A3		THIS DRAWING CONTAINS INFORMATION THAT IS PROPRIETARY TO MOLEX INCORPORATED AND SHOULD NOT BE USED WITHOUT WRITTEN PERMISSION		SHEET NO. 2 OF 2	

molex