

PANEL THICKNESS	X dimension
0.75-1.25	[.030-.049] 19.2-.01 [.756]
1.25-2.0	[.049-.079] 19.4-.01 [.764]
2.0-3.0	[.079-.118] 19.8-.01 [.780]

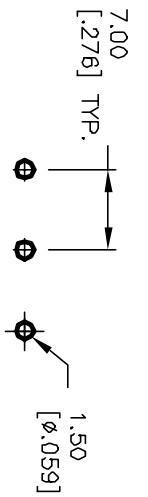

RECOMMENDED P.C.B. LAYOUT

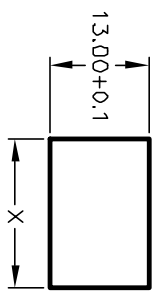
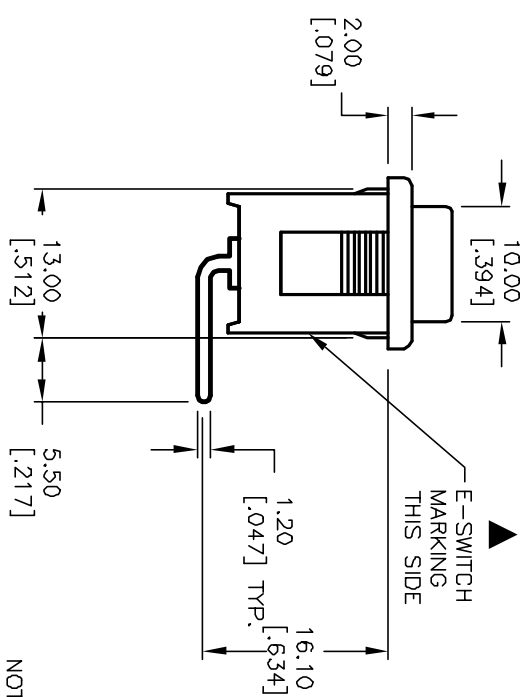
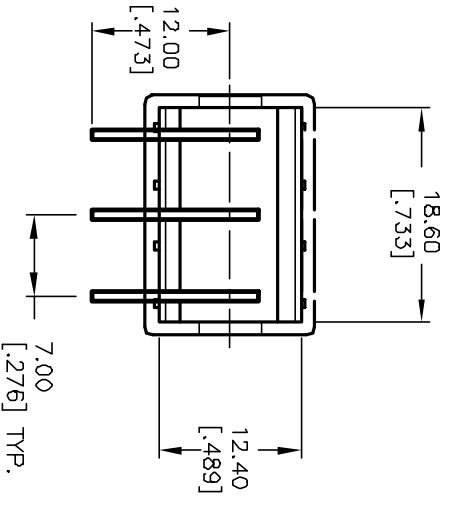
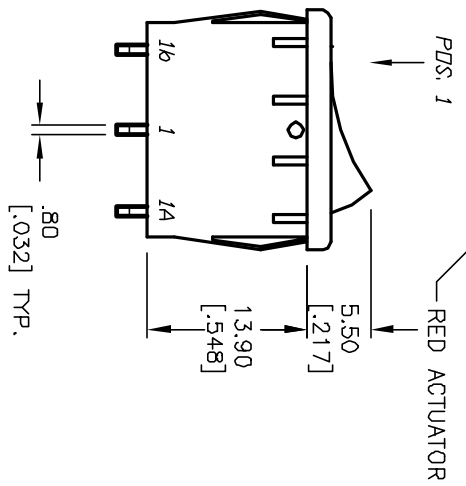
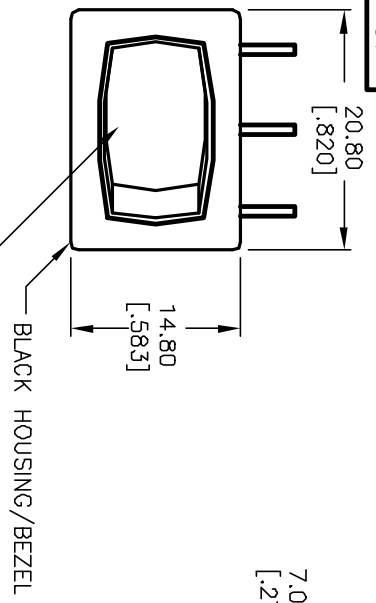

PANEL CUTOUT
NOT TO SCALE

SWITCH FUNCTION	
PDS. 1	PDS. 2
DN	DN
1-1a	1-1b

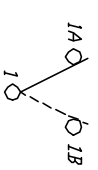

CIRCUIT: SPDT

NOTES:

1. ALL DIMENSIONS IN MM [INCH]
2. GENERAL TOLERANCE: X.X=±0.4 X.XX=±0.25
3. TERMINAL NOS. FOR REF ONLY.
4. RATING: 15A @ 125VAC OR 6A @ 250VAC
5. MATERIALS: TERMINALS: Silver Plated Copper Alloy CONTACTS: Coin Silver, Silver Plated
6. ELECTRIC LIFE: 10,000 cycles
7. CONTACT RESISTANCE: <20 Mega-OHMS
8. INSULATION RESISTANCE: >1000 Mega-OHMS
9. DIELECTRIC STRENGTH: >1500 V 1 minute >3000 V between poles

E-SWITCH®

R1966C BLK RED ER

REV.	ECN No.	DESCRIPTION	DATE	CHKD
A	12125	RELEASED FOR PRODUCTION	5/7/02	CB

TITLE	SCALE	DATE	DR	DWG	REV
R1966C BLK RED ER	1.5:1	5/7/02	CB	M302212	A

THE INFORMATION CONTAINED IN THIS DOCUMENT IS PROPRIETARY TO E-SWITCH AND IS NOT TO BE COPIED OR TRANSMITTED