

CX2155NL

- BALUN TRANSFORMER
- 2-1600 MHz, 1:4
- IMPEDANCE = 75 OHMS
- SURFACE MOUNT

ELECTRICAL SPECIFICATIONS: @ 25°C

INSERTION LOSS:

| FREQUENCY | ATTENUATION(S21) |
|------------|----------------------------|
| 2 MHz | -1.0 dB MAX |
| 4 MHz | -0.8 dB MAX |
| 500 MHz | -0.9 dB MAX |
| 1000 MHz | -1.0 dB MAX |
| 1600 MHz | -1.3 dB MAX |
| *REFERENCE | ATTENUATION |
| 78.5 MHz | -0.6 dB MIN -1.5 dB MAX |

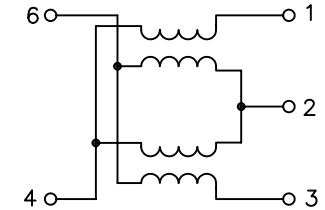

SCHEMATIC

MECHANICAL SPECIFICATIONS:

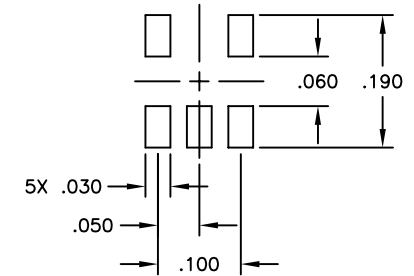
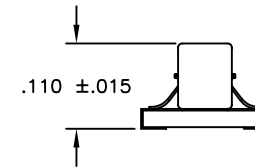
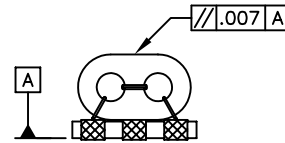
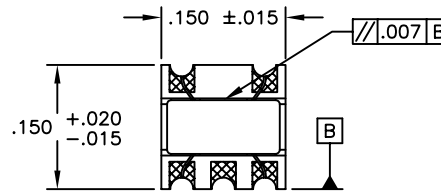

SUGGESTED LAND PATTERN

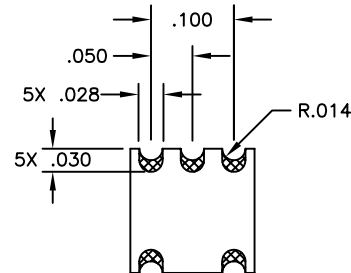

NOTES: UNLESS OTHERWISE SPECIFIED

- OPERATING TEMPERATURE: -40°C TO +85°C
- STORAGE TEMPERATURE: -50°C TO +125°C
- COMPLIANCE TO J-STD:
 - J-STD-002: SOLDERABILITY AT REFLOW PEAK TEMPERATURE OF 245°C
 - J-STD-020: MSL 1, NO MOISTURE SENSITIVE
 - J-STD-075: R6, 250°C MAXIMUM THROUGH REFLOW SOLDER
- DIMENSIONS ARE IN INCHES.
 - TOLERANCE:
 - .XX ±.01
 - .XXX ±.005
- OPTIONAL TAPE & REEL PACKAGING CAN BE ORDERED BY ADDING A "T" SUFFIX TO THE PART NUMBER. ie: CX2155NLT

© Copyright, 2014. Pulse Electronics Corp. All rights reserved. Pulse confidential & proprietary. (09/04/2014)

PRODUCT DESCRIPTION:

TRANSFORMER, BALUN, 1:4, 2-1600MHz, SM

SHEET:

1 OF 1

PART NO.

CX2155NL

DATASHEET REV.

A