

DRAWING MADE IN AMERICAN PROJECTION

LOC R 39 PRINT DIST

© 1973 BY AMP INCORPORATED. ALL RIGHTS RESERVED. AMP PRODUCTS COVERED BY PATENTS AND/OR PATENTS PENDING.

REVISIONS			
LTR	DESCRIPTION	DATE	APPROVED
A	REDRAWN & REVISED PER ECN C-338	5-7-73	<i>AS</i>

Unpublished copy not to be reproduced nor published without written permission of AMP Incorporated

S

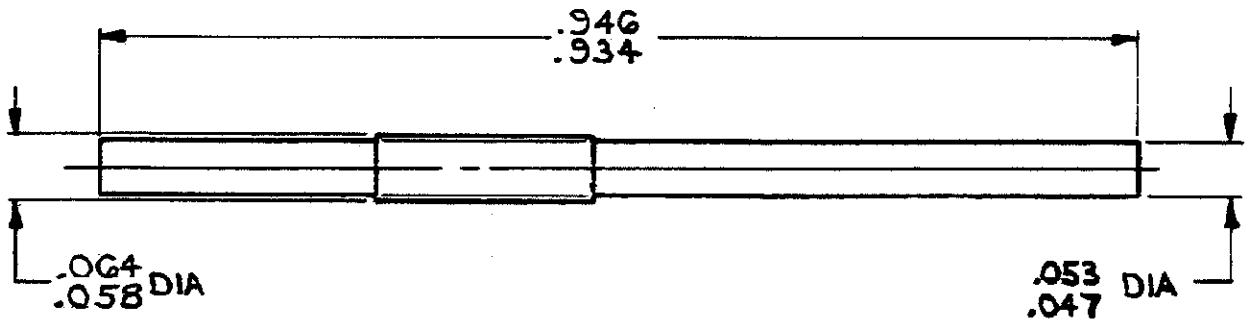

- 204760-1 1. AS SHOWN
- 2. COMPLIES WITH MS27187-3.

UNLESS OTHERWISE SPECIFIED DIMENSIONS ARE IN INCHES TOLERANCES ON: DECIMALS ± .001 ANGLES ± .01	CONTRACT NO.	 AMP INCORPORATED HARRISBURG, PENNSYLVANIA
	DR. <i>Samuel Stolt</i> 5/7/73	
MATERIAL  <b>TEFLON, WHITE</b>	CHK. <i>Robert</i> 5/22/73	NAME <b>SEALING PLUG SIZE 22</b>
	APPR. <i>Samuel Stolt</i> 5/23/73	SIZE CODE IDENT NO. NUMBER
	REL. <i>Robert</i> 5/22/73	<b>A 00779 204760</b>
	DSGN APPD	SCALE
OTHER APPD		