

SUMMARY



Image is for illustrative purpose only

Wires

Low	14
High	0
Coax	0
Triax	0
Quad	0
Fiber	0
Fluidic	0

Series	P
Termination type	Female print 90° PCB
IP rating	50
Cable Ø	0.00 - 0.00 mm
Matching parts	PAG.M1.4GL.AC39B
Status	
Alternative part	

Download

- [Request a quote](#)
- [PCB Eagle Pattern](#)
- [PCB Altium Pattern](#)
- [Catalog](#)

TECHNICAL DETAILS

Mechanics

Shell Style/Model	PK*:
Keying	1 key (alpha=0; Plug: male contact; Receptacle: female contact)
Housing Material	PSU (Polysulfone), gray
Cable Fixing	∅ 0 - 0 mm
Variant	B : White front nut

Performance

Configuration	1P.M14 : 14 Low Voltage
Insulator	
Rated Current	2 Amps

Specifications

- Contact Type: Print (elbow)
- Max. Matings: 2000
- Contact Dia.: 0.5 mm (0.0201in)
- R (max): 8.5 mOhm
- Test voltage (kV rms) Contact-contact: 0.6
- Air clearance min. (mm) or Creepage distance min. (mm): 0.5

Others

F ret (min): 50 N
F ret (max): 150 N
IP Rating: 50

DRAWINGS

Draws

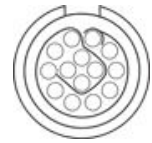
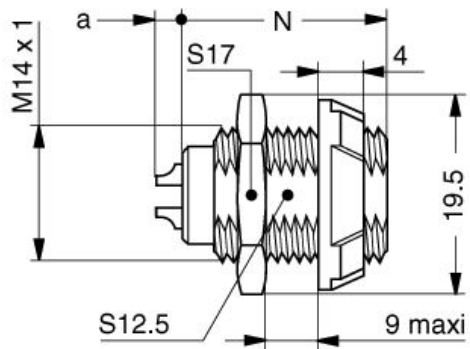

Dimensions

	A	Lmax	N
mm.	19.5	25	20.5
in.	0,77	0,98	0,81

RECOMMENDED BY LEMO

Tools

None

Cables