

THIS COPY IS PROVIDED ON A RESTRICTED BASIS AND IS NOT TO BE USED IN ANY WAY DETRIMENTAL TO THE INTERESTS OF PANDUIT CORP.

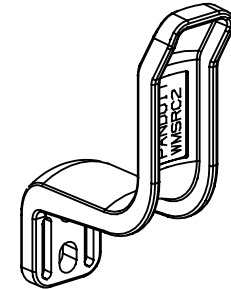
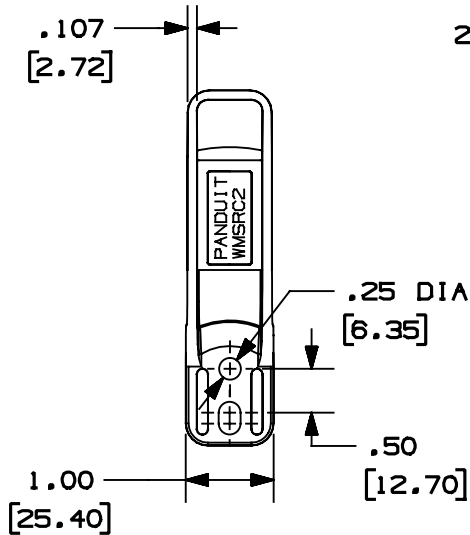
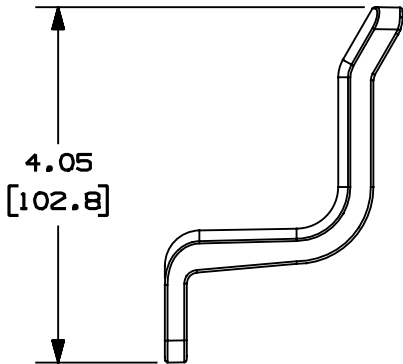
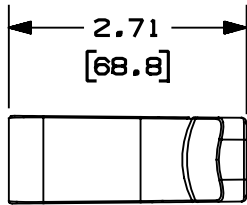

PANDUIT P/N	WEIGHT
WMSRC2**	.46 LB/10 PCS (209.1 G/10 PCS)

- NOTES:
- ** 1. SEE CURRENT CATALOG FOR ADDITIONAL PART SUFFIXES TO INDICATE COLOR AND OR PACKAGE QUANTITY.
 - 2. TO BE USED WITH WMPH2. CAN BE MOUNTED ON LEFT OR RIGHT BACKSIDE OF WMPH2.
 - 2. ALL DIMENSIONS IN PARENTHESES ARE IN METRIC.

OLD FILENAME/LAYERS D35544CT_DC_STRAINCLIP_00A.PRT

PANDUIT CORP. TINLEY PARK, ILLINOIS
 WIRE MGMT. STRAIN RELIEF CLIP
 FOR WMPH2 (WMSRC2)
 CUSTOMER DRAWING

UNLESS OTHERWISE SPECIFIED,
 DIMENSIONAL TOLERANCES ARE:
 (.X) ± (.XXX) ± .010 (.3)
 (.XX) ± .03 (.8) ANGLES ±

UNLESS OTHERWISE SPECIFIED,
 ALL DIMENSIONS ARE GIVEN
 IN INCHES, THIRD ANGLE PROJECTION.

DRAWN BY JBA	MAT'L: NYLON	SCALE NONE	DWG NO. 35544-43	DWG SIZE A
DATE 6-17-97				
CHK'D				

REV	DATE	BY	CHK	DESCRIPTION	ECN - R	CUST	SUP
R	6-17-97	JBA		RELEASED TO PRODUCTION	35544-43		